



**REFERENCE MARKS**

STN	TO	ORIGIN	BEARING	DIST
1	OIP	RP860821	34°19'	2.2
2	Pin		96°58'30"	1.06
3	OIP	RP111930	97°00'30"	2.012
4	OIP	RP111930	6°58'	1.006
4	OIP	RP111930	96°59'	1.006
5	OIP	RP111930	276°59'	1.006
5	OIP	RP111930	7°02'30"	1.006

**PERMANENT MARKS**

PM	ORIGIN	BEARING	DIST	NO
1-PM		166°44'	2.23	127144
3-PM		167°11'	2.83	127145

*Original information compiled from  
RP111930 in the Department of Natural  
Resources.*

*Peg placed at Stns 1 & 2*

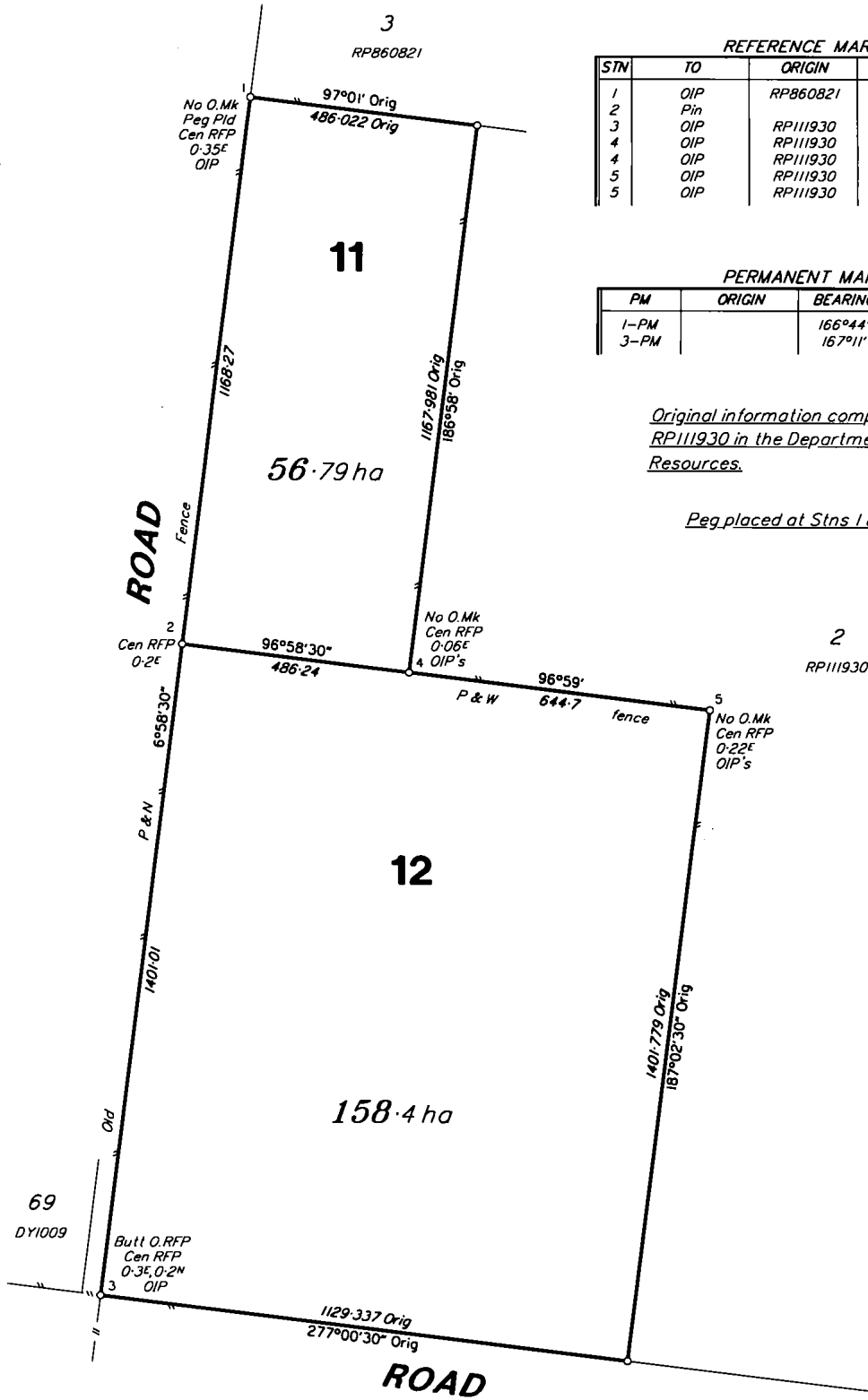

Scale 1:10000 - Lengths are in Metres.

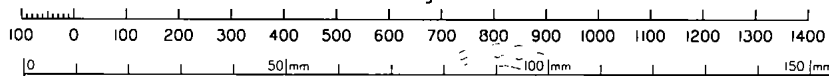

I, Geoffrey Lynn HANSEN, hereby certify that I have surveyed the land comprised in this plan personally, that the plan is accurate, that the said survey was performed in accordance with the Surveyors Act 1977 and the Surveyors Regulation 1992 and that the said survey was completed on 14/7/2000

Date 17/7/2000 Licensed Surveyor

**Plan of Lots 11 & 12**

*Cancelling Lot 1 on RP111930*

**PARISH: WEALE COUNTY: Derby**

Meridian: AMG, Zone 56, Derived from plan DY591

F/N's: No

Scale: **1:10000**

Format: **STANDARD**



**SP134957**

Plan Status:

DRAWN - STANFIELDS

GH000778

0029

704257222

\$307.00  
18/08/2000 12:39

BE 400 NT

**WARNING : Folded or Mutilated Plans will not be accepted.  
Plans may be rolled.  
Information may not be placed in the outer margins.**

Registered

5. Lodged by

PETER ATKINSON & COMPANY *ool*

(Include address, phone number, reference, and Lodger Code)

1. Certificate of Registered Owners or Lessees.

I/We LEIGH VERNOR JOHNSTON  
MARLI ELIZABETH JOHNSTON TENANTS IN COMMON

(Names in full)

\* as Registered Owners of this land agree to this plan and dedicate the Public Use Land as shown hereon in accordance with Section 50 of the Land Title Act 1994.

\* as Lessees of this land agree to this plan.

*Leigh Vernor Johnston*  
*Marli Elizabeth Johnston*  
Signature of \* Registered Owners \* Lessees

6 Existing			Created		
Title Reference	Lot	Plan	Lots	Emts	Road
50169995	1	RP111930	11 & 12		

\* Rule out whichever is inapplicable

2. Local Government Approval. **WAMBO SHIRE COUNCIL**

\*  
hereby approves this plan in accordance with the :  
% **INTEGRATED PLANNING ACT 1997**

Dated this 21<sup>st</sup> day of July 2000

**CR ROBERT MCGREGOR WILD**  
**MAYOR** # *[Signature]*  
**MR. COLIN ALFRED O'CONNOR**  
**CHIEF EXECUTIVE OFFICER** # *[Signature]*

\* Insert the name of the Local Government. % Insert Integrated Planning Act 1997 or Local Government Planning & Environmental Act 1990  
# Insert designation of signatory or delegation

3. Plans with Community Management Statement :  
CMS Number :  
Name :  
4. References :  
Dept File :  
Local Govt :  
Surveyor : 0029

Por. 12	11 & 12	12. Building Format Plans only. I certify that : * As far as it is practical to determine, no part of the building shown on this plan encroaches onto adjoining lots or road; * Part of the building shown on this plan encroaches onto adjoining * lots and road Licensed Surveyor/Director * Date <del>delete words not required</del>
Orig	Lots	
7. Portion Allocation :		13. Lodgement Fees : Survey Deposit \$ ..... Lodgement \$ ..... ..... New Titles \$ ..... Photocopy \$ ..... Postage \$ ..... TOTAL \$ .....
8. Map Reference : 9143-31333		
9. Locality : TIPTON		14. Insert Plan Number <b>SP134957</b>
10. Local Government : WAMBO S.C.		
11. Passed & Endorsed : By : <u>G.I. HANSEN</u> Date : <u>18-07-2000</u> Signed : <i>[Signature]</i> Designation : <u>Licensed Surveyor...</u>		

GH000778